

BUILDING

3

5
ROOM

I Model Penthouse

Apartment: 130.5 meters
Balcony: 94+4.3 meters

NEW
TALPIOT

MY JERUSALEM HOME

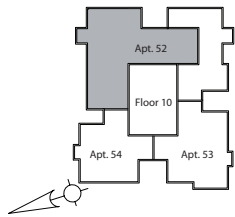

Technical Specifications

All premium apartments offer exclusive specifications. Buyers have the option to select the type of floors, tiles and bathroom fixtures of their choice from three leading companies, which will be chosen by the developer.

General - Exterior

A residential neighborhood with a luxuriant indoor park spanning across 1.5 acres of stunning grounds of leisure, shopping and amenities.

- Two consecutive underground parking spaces
- A grand, luxurious lobby
- 2 high-speed, beautifully styled elevators
- Stone/glass-finished balcony panels with aluminum foam
- Authentic Jerusalem stone coating
- One storage unit per apartment at parking level

Home Interior

Flooring and Wall Tiles

- Granite floor tiles measuring 80X80 in the living room and common areas of the apartment, and 60X60 in the bedrooms
- Bathroom flooring measures 20X20, 33X33
- Optional parquet laminate flooring for Master bedroom
- Bathroom wall tiles in various sizes with a selection of colors, up to 2 meters high
- Caesarstone countertops in the kitchen with 4 color options
- Surface mounted sinks to choose from two different showrooms

Cabinets and Bathroom Fixtures

- Pull-out kitchen faucets installed on all sinks
- White sinks in all bathroom units
- Wall-hung toilets with concealed tanks
- A lower bathroom cabinet in all units (cabinets are sandwich plywood in both bathrooms units)
Sizes 0.60-0.80 with a mirror
- Shower in Master Bedroom
- Upper and lower sandwich plywood cabinets (up to 8 meters in length subject to total kitchen area), Two leading companies to choose from
- Kitchen sink – stainless steel / silliquartz

Doors and Windows

- Apartment entry door - stylish security door
- The mamad (reinforced security room) contains an additional wooden door.
- Interior doors – Wooden doors with finished plywood and curved lintels, Hamadia or equivalent + gasket, full rubber or flax board filling
- Aluminum windows with insulated glass (except in security room)
- Shutters - Aluminum foam
- Electric blinds in the all rooms except security room

Electrical Fittings and Connections

- Central air conditioning system with dropped ceiling
- Three-phase electric power 3X40
- Phone jack and cable in bedrooms and living room
- One closed-circuit TV intercom unit, and an additional unit in the Master Bedroom without a screen
- Home theater connections in living room
- Switches and a switch breaker - Master Bedroom (including power outlets, phone jack and cable).
- Dishwasher connections, including an electrical outlet, a water line and drain

Sales Office: 156 Derech Beit Lechem, +972-2-673-2244

Please note that all information and images in this site, are for illustrative purposes only. Individual features may vary